

1"03



THE EZ PANEL SUKKAH

Assembly Instructions



PANEL ASSEMBLY

All panels (and corner sections on some models) work on a Male/Female assembly system. Using two Male sides or two Female sides, will not interlock.

Please ensure the white caps are on the top side of the panel, & the light wood color side, is on the inside of the sukkah (dark outside).

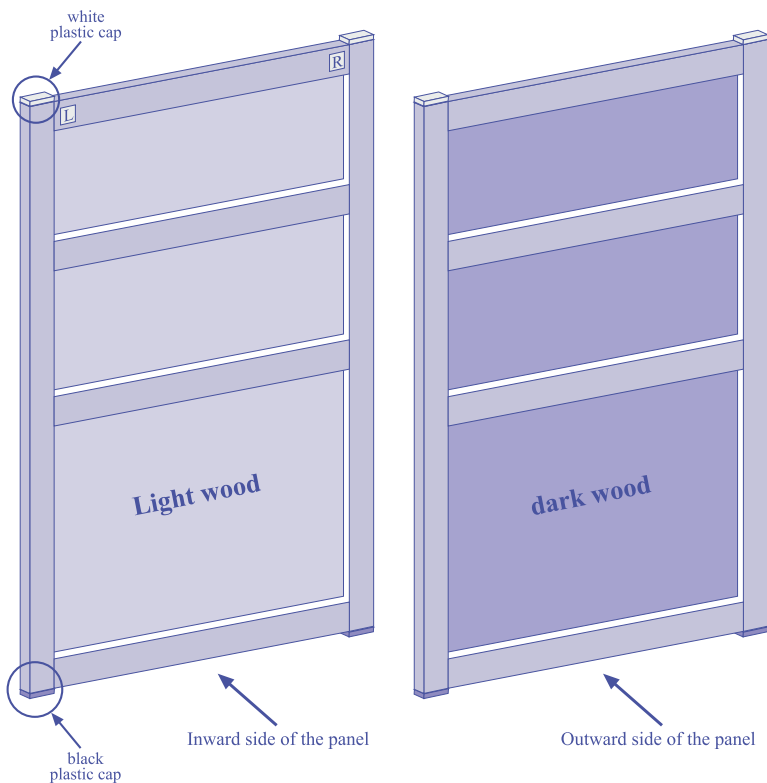

CORNER ASSEMBLY

First layout the sukkah panels the way you would like to set it up.

Position panels at a 45° angle, then hook male side of panel (1), into the female front side of panel (2) (to the left of it), then swing in the direction of arrow shown in diagram to create a corner, (use corner section on some models)

Please ensure the interlock is properly connected from top to bottom.

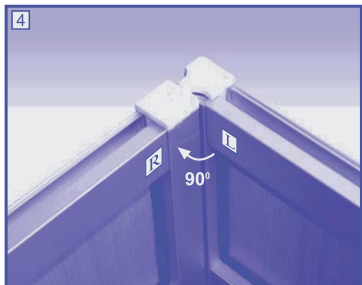
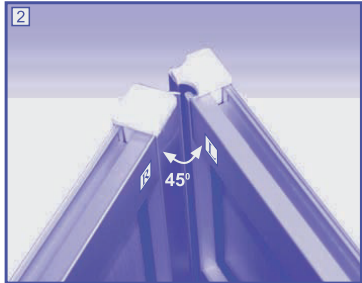

HOW TO CONNECT THE SIDE PANELS

Place panels side by side, position the 2 panels at a 135° angle, then insert male (R) side of panel (1) into female side (L) of panel (2), (as shown in diagram). Swing panels into place. (see arrow)

Please ensure the interlock is properly connected from top to bottom.

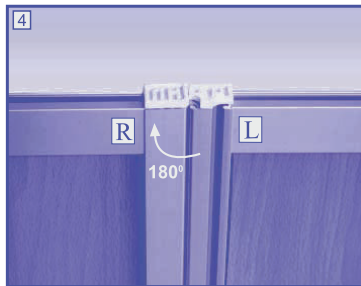
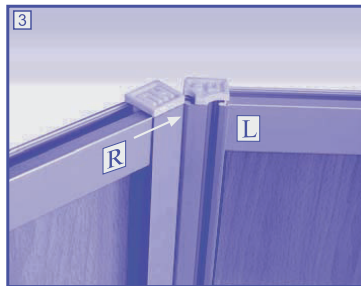
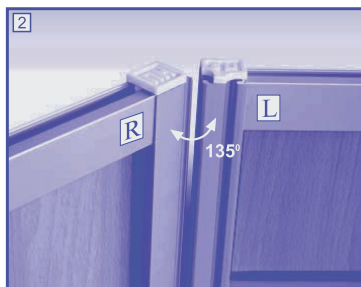
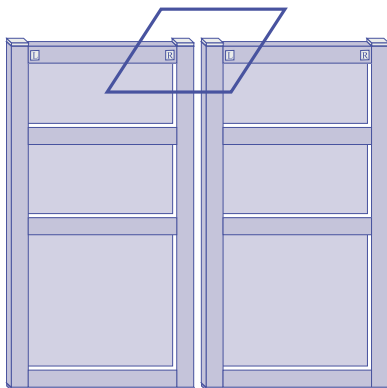

THE ORDER IN WHICH TO CONNECT THE PANELS

Please note doors & windows are interchangeable with a standard panel of the same size.

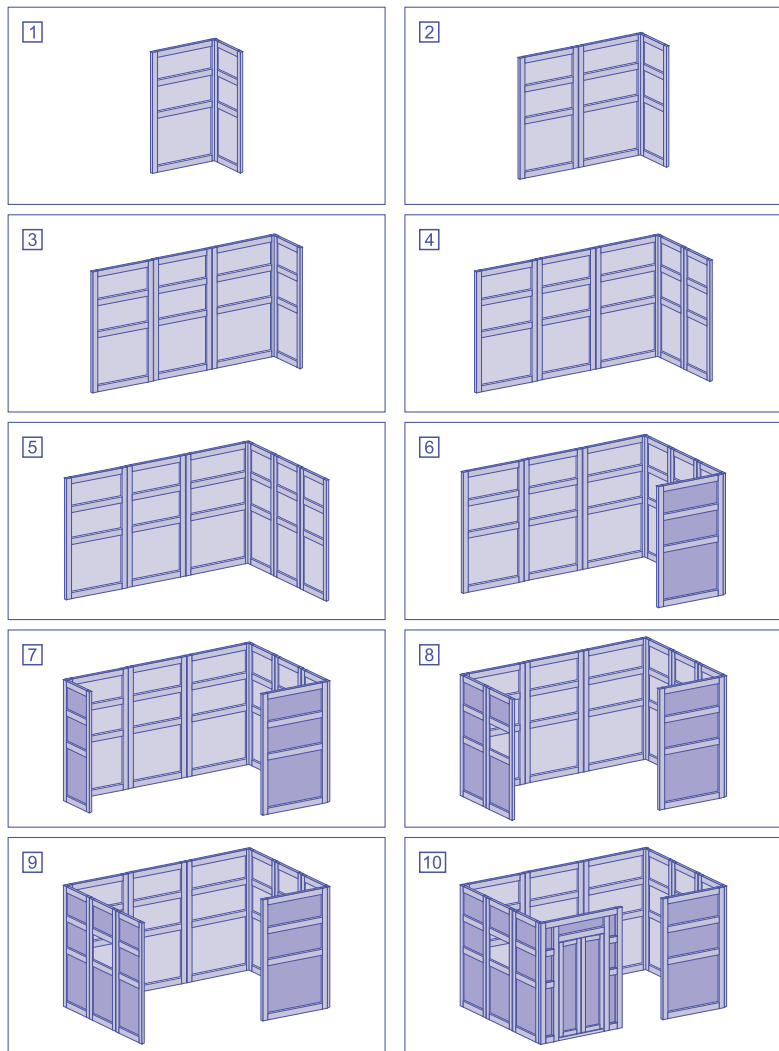

HOW TO CONNECT THE LAST PANEL

1. After completing diagram (10) connect the last panel in the middle on one side.
2. Push the 2 edges of the last 2 panels outwards, connect the male/female connection,
3. After ensuring the interlock is properly connected from top to bottom, pull back in to the straight position.

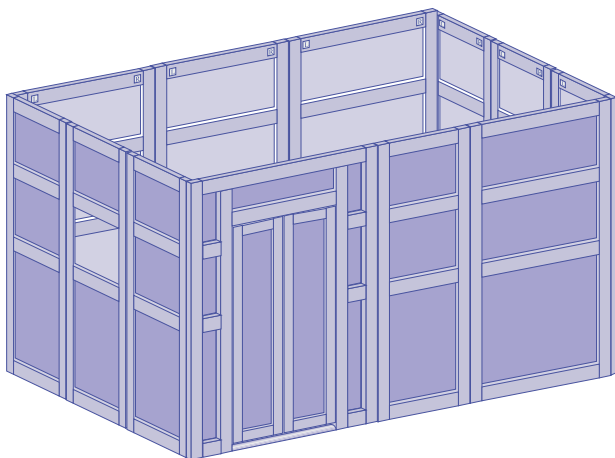
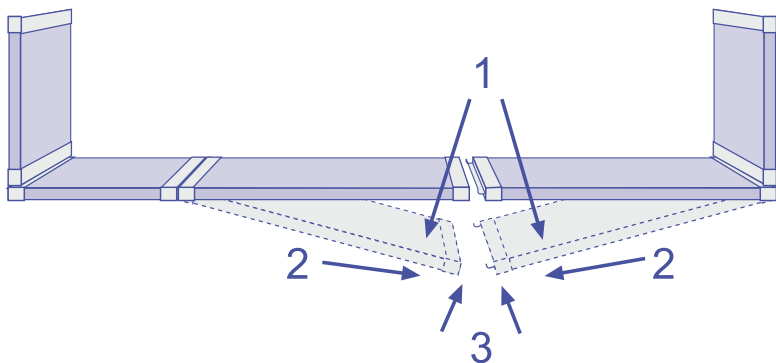

PANEL CONNECTOR INSTALLATION

After each panel to panel connection is made, use the connector (see diagram) to help keep the panels together. Connectors should be placed on the top of the panels, where the 2 panels connect. Use the corner connector over each corner, to keep the corners straight.

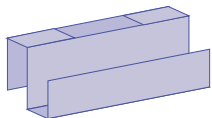

Big Connector

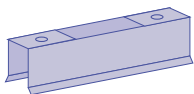

Small Connector

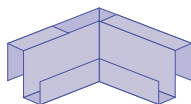

Corner Connector

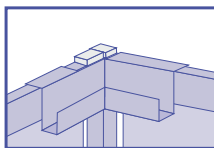
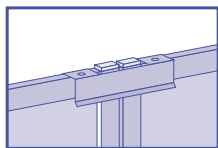
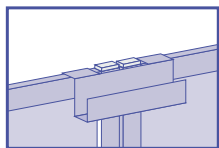
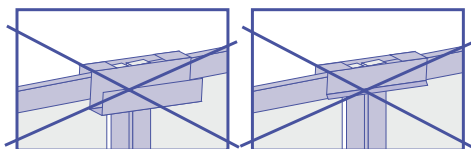

Please make sure that the connector is placed in its proper place so that the white plastic caps protrude above the connector surface (as shown in the above sketches)

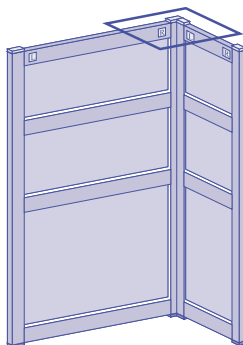
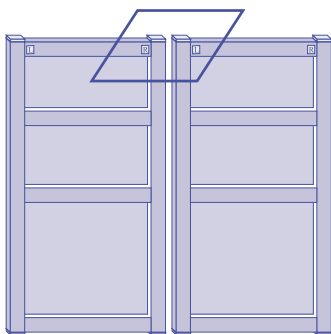

HOW TO ATTACH THE HANDLES

In the center of the door there are two holes for the purpose of attaching the handles.

There are two holes on the left side and two holes on the right side. The holes are closed by plastic plugs.

Please take out the plugs from the holes on the side you wish to open (the side you opened the hinges) You must screw on the handles from both sides of the door

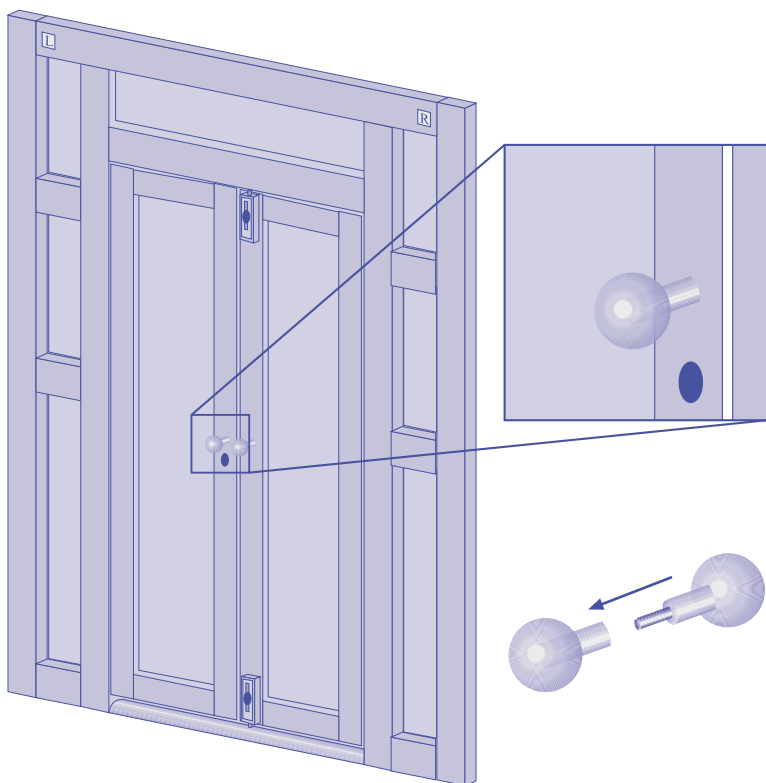

SUKKAH WOOD SIZE CHART

In order to strengthen the walls of the Sukkah, place wood inside the panel connectors around the top perimeter of the Sukkah, see size chart below.

If you are able to cut the wood, it is best to place the wood from corner to corner.

Please note on a standard size wood beam, it should be cut 6" shorter than the size of the sukkah wall.

6'	5.5' 2 X 3
8'	7.5' 2 X 3
10'	9.5' 2 X 3
12'	11.5' 2 X 3
14'	13.5' 2 X 3

TOP OF SUKKAH WOOD BEAM PLACEMENT

Place 1 beam holder over the top over of the panel, then clip into place. Place 1 holder for each side of the 2" x 3" wood beams (2 per beam) on the top of the Sukkah, beams should be placed approximately every 4'.

Wood beams should hang over the sukkah 1' on each side.